

SF-34M

Desktop 4 Plates A3 Paper Folding Machine

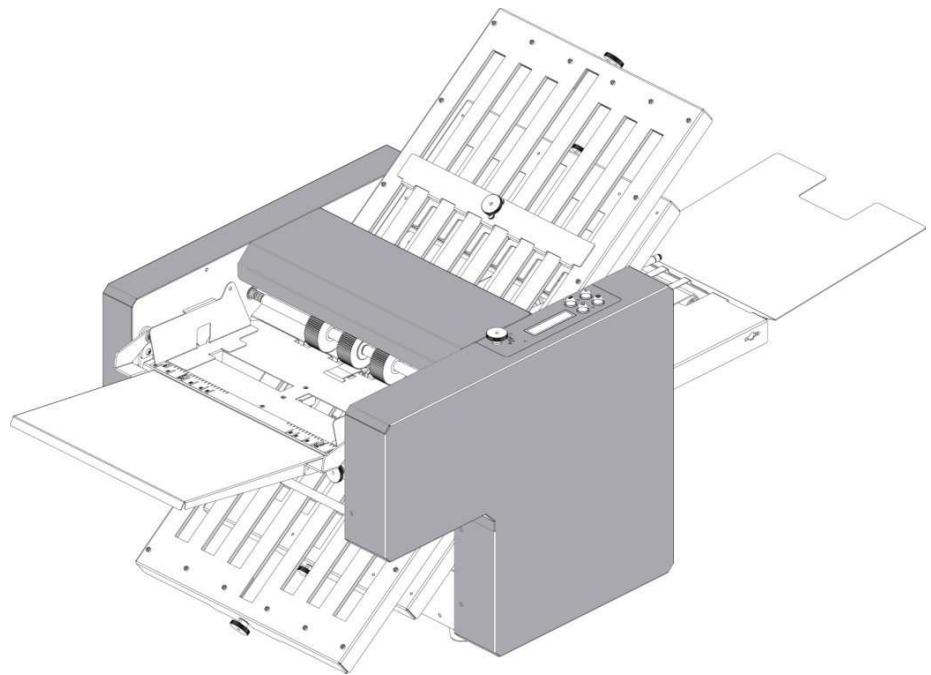

1. Installation.....	1
2. The LCD Control Panel.....	4
3. Setting Custom Folds.....	5
4. Folding alignment.....	7
5. Troubleshooting.....	9
6. Maintenance and cleaning.....	12
7. Function introduction.....	13
8. Technical Parameters.....	14

1. Installation

Installation Process: Unpackaged → Open the loading table → Install the feeding table → Install the fourth folding plate → Install the 2nd folding plate → Install the 3rd folding plate → Install the 1st folding plate → Install delivery table → Install transition board → Connect to Power → Power on the machine

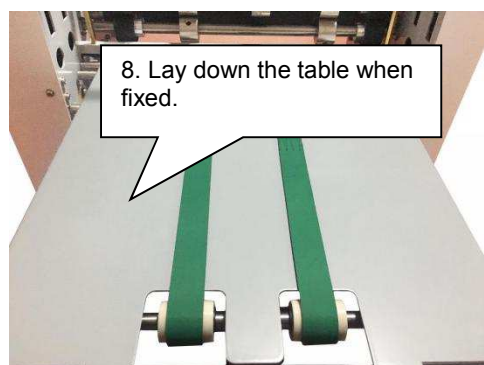
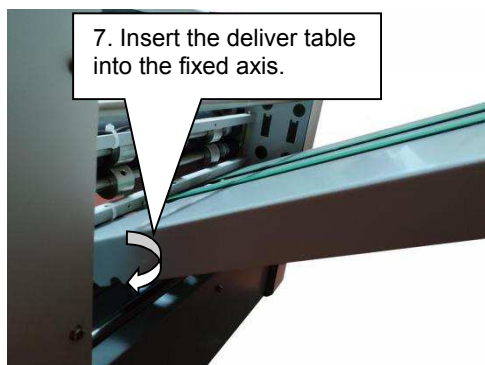
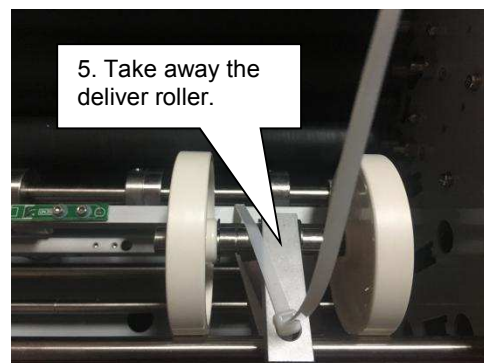
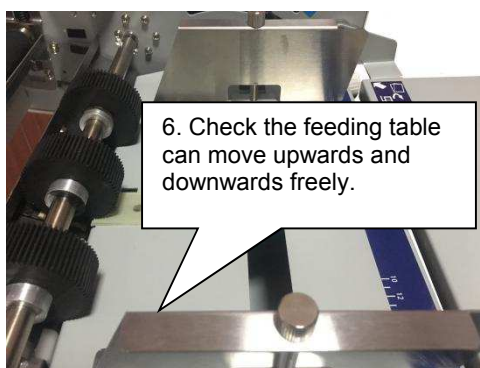
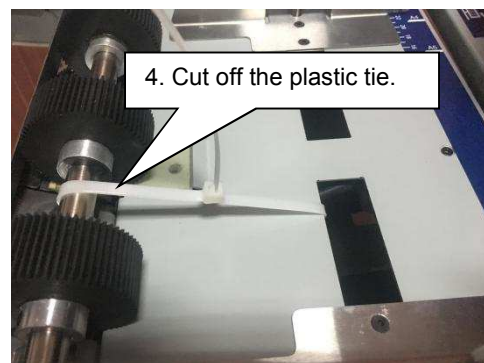
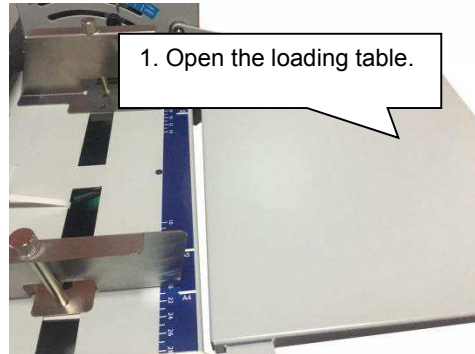
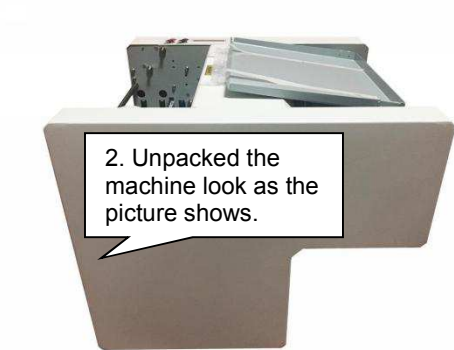

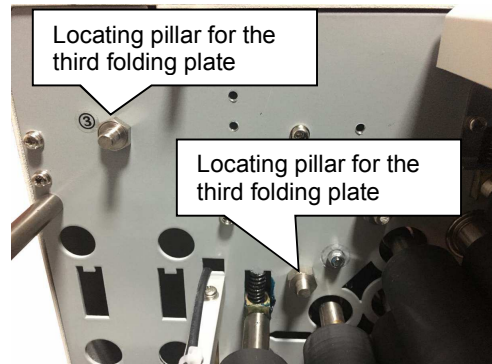
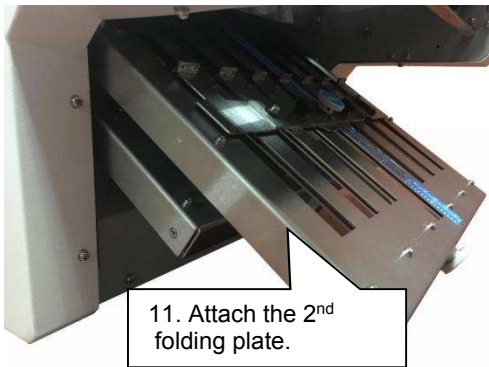
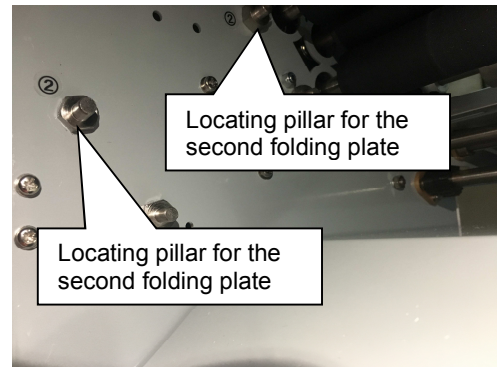
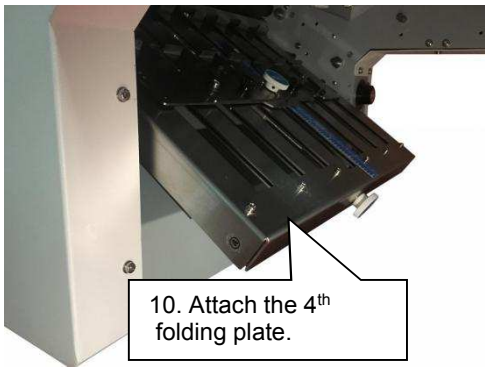
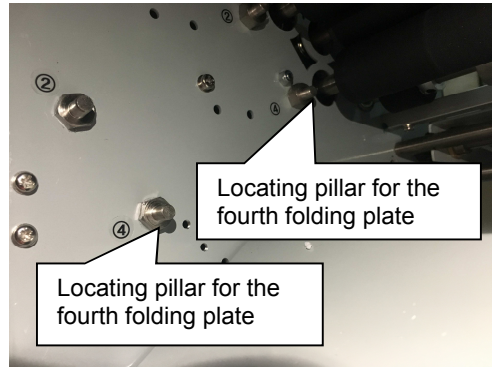
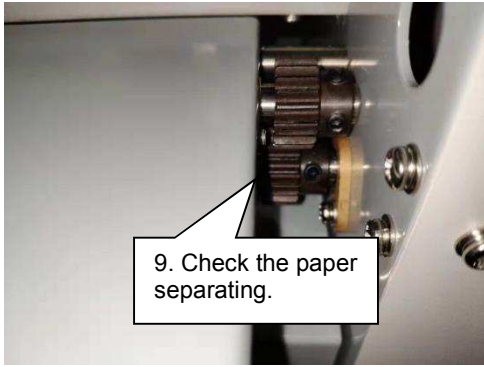

Note: The four grooves of the folding plate must be attached to the four Locating pillars completely.

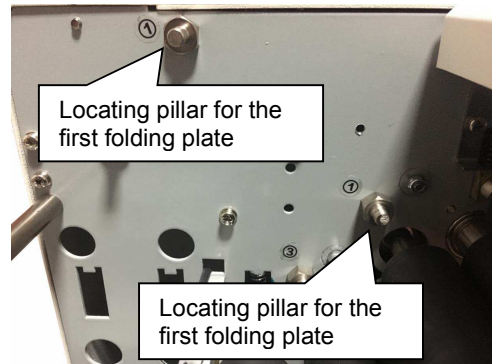
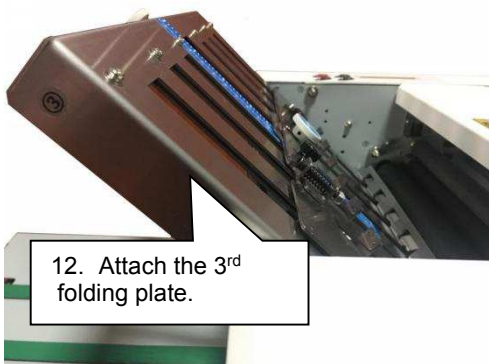

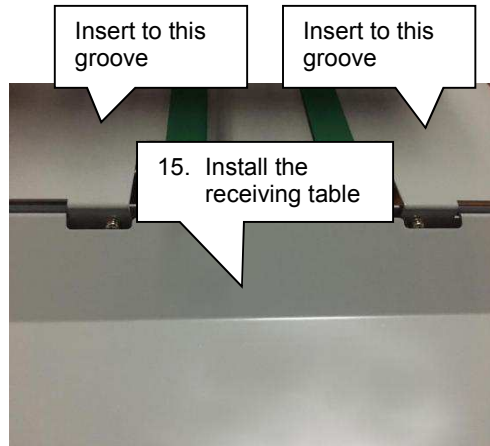
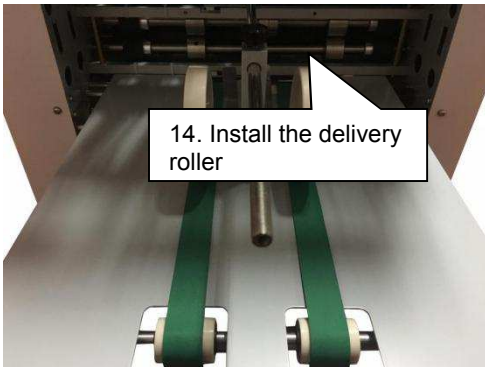
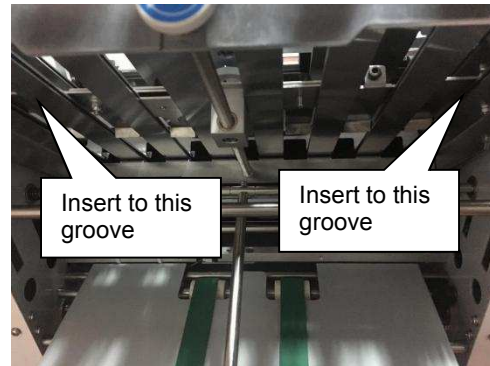
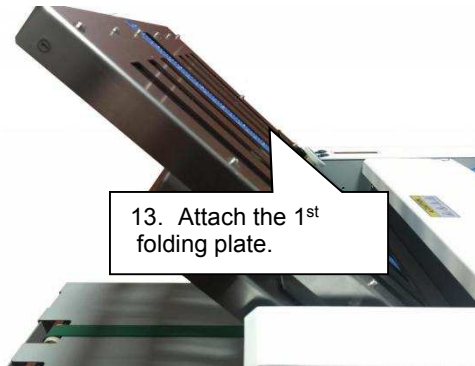

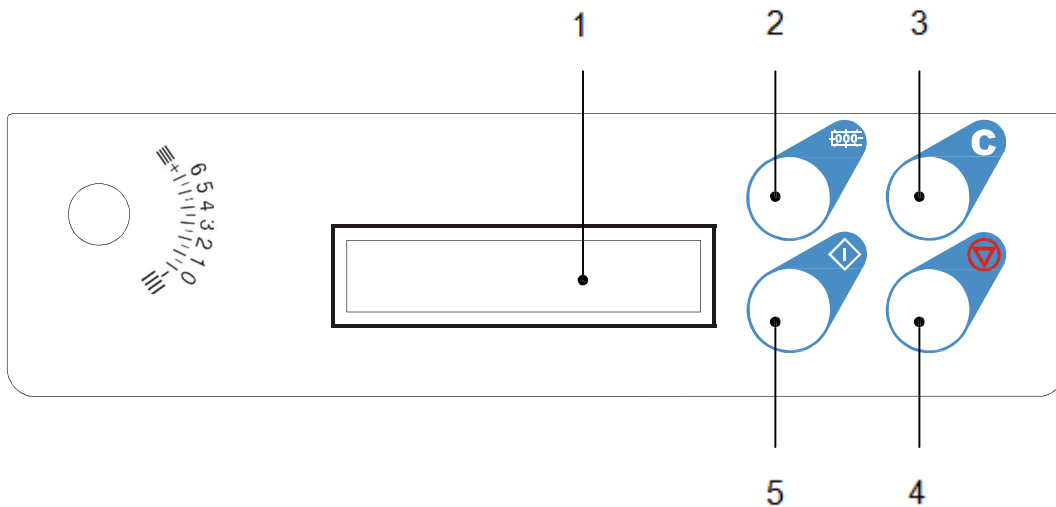

2. The LCD Control Panel



NO	Name	Function
1	Counter/LCD display	Displays status, counter, batch counter, any faults
2	Batch button	Press to change batch counting quantity and interval
3	C (clear) button	Press to clear counter
4	Stop button	Press to stop operation
5	Start button	Press to start operation operations

AutoBatch Counting:

To fold a set number of sheets with a pause between sets, use the AutoBatch Counter. Press the Batch button  repeatedly to set the number of sheets to be folded, and then press the red Stop button  to set the number of seconds between each set (up to 30 seconds). Press the Batch button  to adjust the time delay (the delay will cycle up to 30 seconds and then go back to 0).



AutoBatch Last Form Adjustment:

The speed of the last three forms can be adjusted when using AutoBatch for accurate sets.

For example, if 10 sheets are programmed in AutoBatch and 11 are pulled, the speed of the last three forms needs to be reduced, if only 9 sheets are pulled the speed of the last three forms needs to be increased. To enter the last form adjustment mode press and hold the

Stop button  for 3 seconds, the screen will read "M_Count: ### MS", note the number

shown, then press the Batch button  to adjust the speed (the speed will cycle up to 495

MS and then go back to 005). To increase the speed, set to a higher number and to decrease

the speed, set to a lower number. To exit press the Stop button  one time.

3. Setting Custom Folds

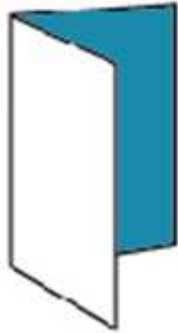

Single fold

1st P: 1/2 paper length

2nd P: 0 Move the folding buffer to green area

3rd P: 0 Move the folding buffer to green area

4th P: 0 Move the folding buffer to green area

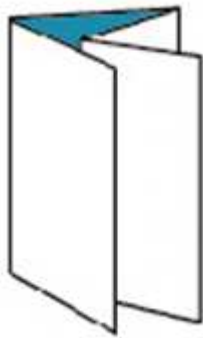

Double fold

1st P: 1/2 paper length

2nd P: 1/4 Paper length

3rd P: 0 Move the folding buffer to green area

4th P: 0 Move the folding buffer to green area

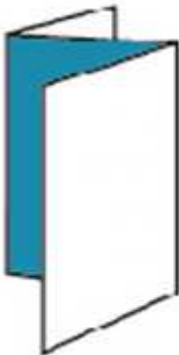

Outside triple

1st P: 1/3 paper length

2nd P: 1/3 paper length

3rd P: 0 Move the folding buffer to green area

4th P: 0 Move the folding buffer to green area



Inside triple

1st P: 2/3 paper length

2nd P: 1/3 paper length

3rd P: 0 Move the folding buffer to green area

4th P: 0 Move the folding buffer to green area

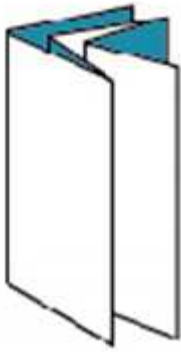

Triple fold

1st P: 1/2 paper length

2nd P: 1/4 paper length

3rd P: 1/8 paper length

4th P: 0 Move the folding buffer to green area

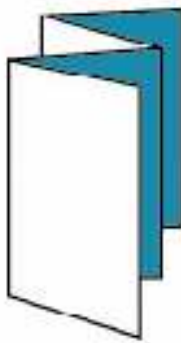

3 Accordion fold

1st P: 1/4 paper length

2nd P: 1/4 paper length

3rd P: 1/4 paper length

4th P: 0 Move the folding buffer to green area



Pocket triple

1st P: 3/4 paper length

2nd P: 1/4 paper length

3rd P: 0 Move the folding buffer to green area

4th P: 1/4 paper length



4 Accordion fold

1st P: 1/5 paper length

2nd P: 1/5 paper length

3rd P: 1/5 paper length

4th P: 1/5 paper length

4. Folding alignment

Case One

Output direction

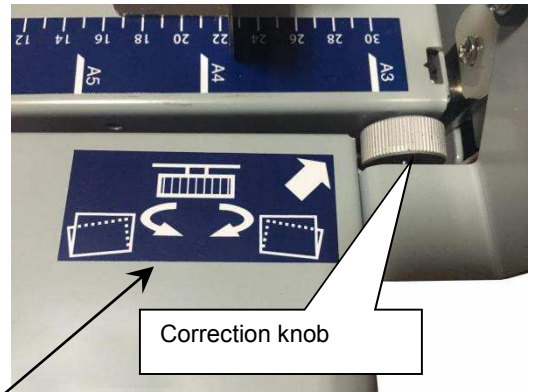
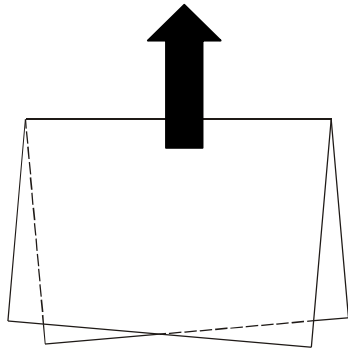

When this case occurred, turn the slant correction knob to correct the misalignment as the guidance showed.

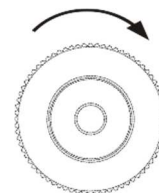
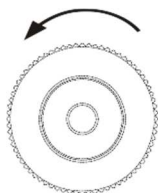
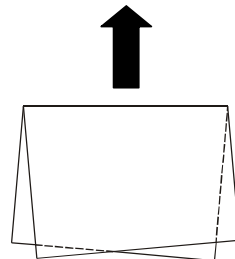
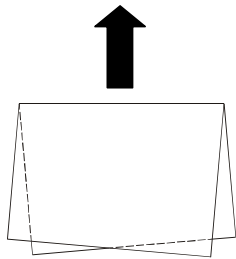

Case Two

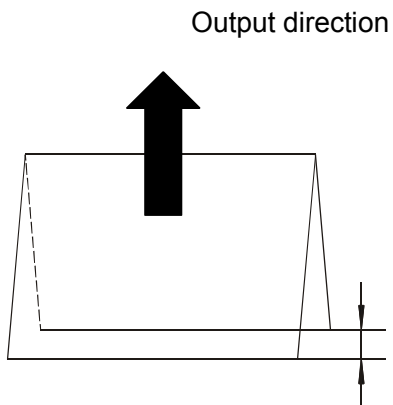

Case Two:

When this case occurred, use the adjustor on the top of the folding plate to correct.

Take the 4 Accordion fold as an example:

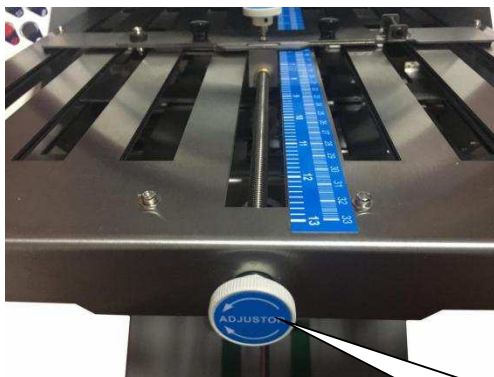
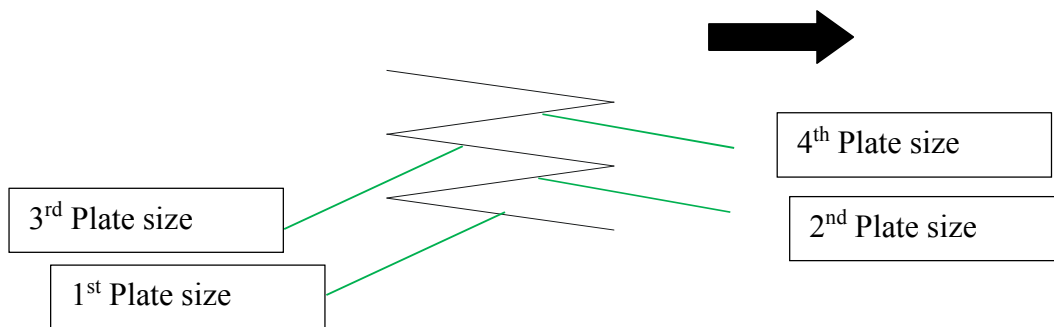

Clockwise - - - Increase the folding size.
Anti-Clockwise - - - - Decrease the folding size.

5. Troubleshooting

Deformed Folding

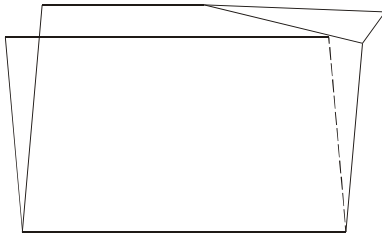

Please follow below steps:

- Fan the paper completely
- Check the folding plates are correct installed
- Spray a commercially-available air duster on the rubber roll because of the

Paper Jam

When there is paper jam, the LCD will display "PAPER ERR". Please check the machine and follow below steps to get rid of the jammed paper:

A. Jammed at friction feeding roller

- Pull out the jammed paper directly

B. When Paper Has Slipped at the Paper Feed Section

- Mis-feeding frequently occurs using thick paper, set the paper feed pressure adjustment knob to "Thick paper."
- Fan the paper well before stacking.
- Decrease the stacking amount of paper.

C. Paper Coiled Around the Rubber Roll

- Power off the machine first!
- Open the top cover, turn the roll backward with both hands and then pull out the jammed paper.

D. Paper Jammed at the First Folding Plate Power off the machine first!

- Remove the first folding plate from the machine.
- Open the top cover.
- Pull out the jammed paper.
- Install the first folding plate.

E. Paper Jammed Near the Stacker

- Pull out the jammed paper directly.

ERROR

Message	Cause	Solution
NO PAPER	When the power is turned on, there is no paper on the paper feed table.	Stack paper on the paper feed table.
NO PAPER/**** (the number of folded paper)	After paper is fed and folded, there is no paper left on the paper feed table.	Stack paper on the paper feed table. The number of folded paper will be displayed again.
PAPAEER ERR	A paper jam has occurred.	Remove the jammed paper and press the clear button.
OVER LOAD	The motor is overloaded.	Turn off and repower on the machine.

Troubleshooting

Troubles	Cause	Solution
The machine doesn't start even when the start button is pressed.	The power cord is not inserted to the wall socket.	Insert the power cord to the wall socket.
	The power is not on.	Turn on the power switch.
	Paper has not reached the guide plate of the paper feed table.	Push in the paper until its lead edge touches the guide plate.
	A paper jam has occurred inside the machine.	Remove the jammed paper
	A trouble has occurred inside the machine.	Call your dealer
When the start button is pressed, the paper feed rings rotate but no paper is fed.	The paper feed table has been lowered.	Lower the paper set lever to raise the paper feed table.
	The paper has not been fanned well.	Fan the paper well
	The paper is curled	Straighten the paper curl.
	The paper is thick	Set the paper feed pressure adjust knob to "Thick paper".
	The paper is outside the specification.	Use paper in specifications.

The paper is not folded at the proper folding position.	The paper folding plate is not installed properly.	Install the paper folding properly.
	Static electricity has occurred in the paper.	Spray a commercially-available air duster on the rubber roll because the static electricity.
Paper is double-feed frequently	The paper feed pressure adjustment knob is set to "Thick paper".	Set the paper feed pressure adjust knob to "Thin paper".
	The paper separator is dirty.	Clean it with alcohol.
	The paper is outside the specifications.	Use paper in specifications.
	Any trouble has occurred inside the machine	Call your dealer
Paper slips at the paper feed section frequently.	The paper feed pressure adjustment knob is set to "Thin paper".	Set the paper feed pressure adjust knob to "Thick paper".
	Static electricity has occurred in the paper.	Clean it with alcohol.
	The sheets of paper are sticking to each other and cannot be separated.	Fan the paper well.
	The paper is outside the specification.	Use paper in specification.
	A trouble has occurred inside the machine	Call your dealer.
Paper jams frequently.	The rubber roller is dirty.	Clean it with alcohol
	Paper shreds are stuck inside the paper conveyance passage.	Check inside the machine and remove any paper shreds.
	The stacker rollers position is not correct.	Adjust the position of the stacker rollers.
	The paper is curled.	Straighten the paper curl.
	Static electricity has occurred inside the machine.	Call your dealer.
Paper slips in the vertical direction.	After a paper type was changed, a folding position has not been adjusted.	Check that the rough adjustment knob position is correct.

Paper slips in the horizontal direction.	The paper is stacked unevenly.	Stack the paper neatly on the paper feed table.
	There is space between the paper and side guide.	Set the side guides so that they push against the paper lightly.
	The rubber roll is deformed.	Call your dealer
Paper jam at the rubber roll when thick paper or cross folded thick paper is folded into two.	The paper is outside the specifications.	Use paper that meets specifications.
	The space inside the internal paper conveyance passage is narrow.	Widen the space using the fine adjustment knob of the second folding plate.
Small paper is fed continuously(stream-fed)	The paper is outside the specifications.	Use paper that meets specifications.
	The paper feed pressure adjustment knob is set to "thick paper".	Set the paper feed pressure adjustment knob to "thin paper".

6. Maintenance and cleaning

Paper debris and oil on the friction feeding roller will make the malfunction, please do weekly cleaning.

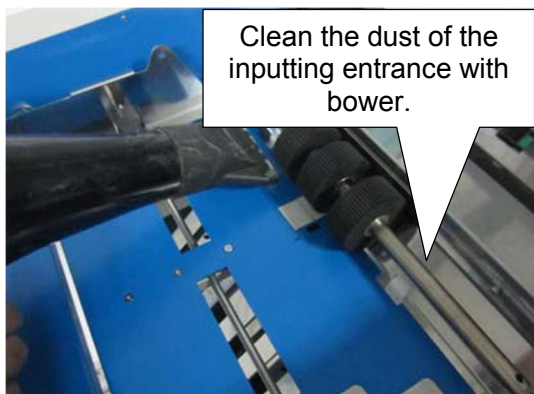
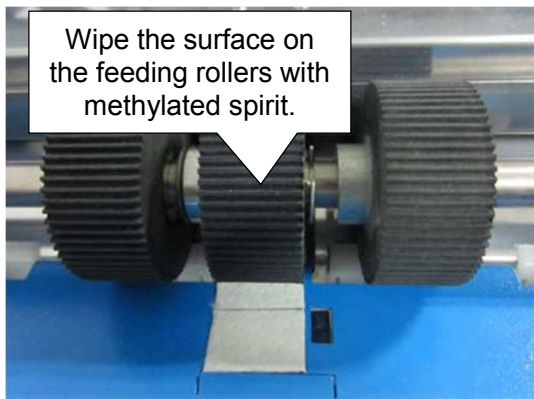

The folding roller and the separator are wearing parts and must be exchanged when they are worn.

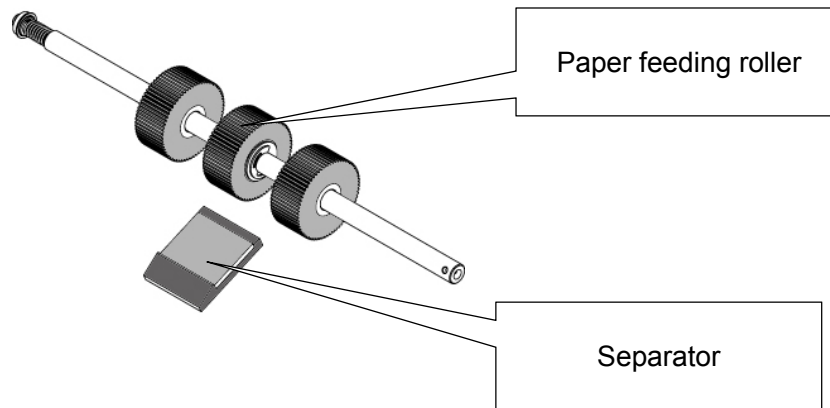



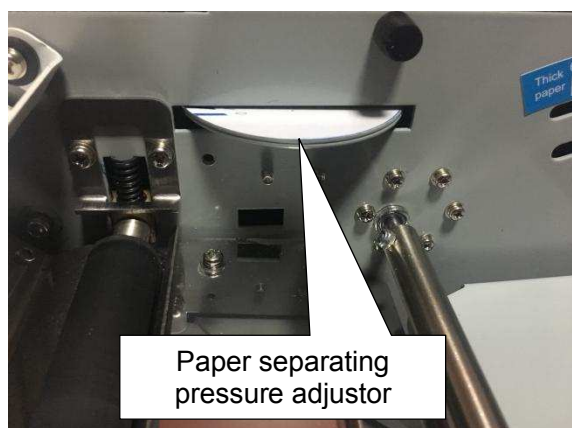
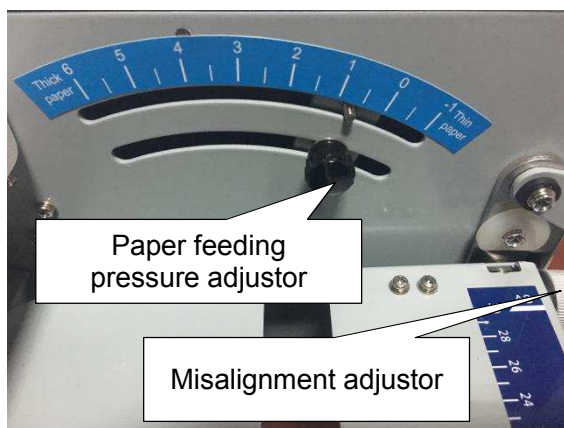
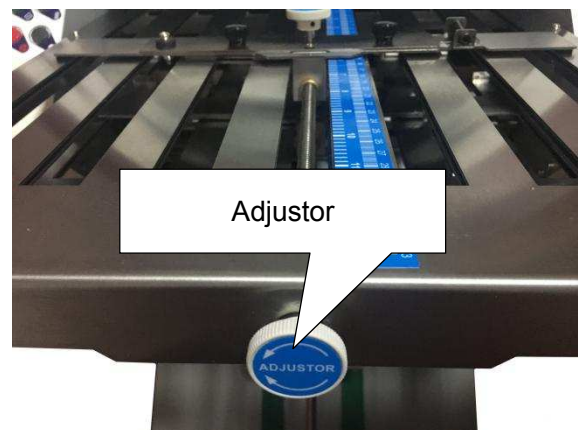
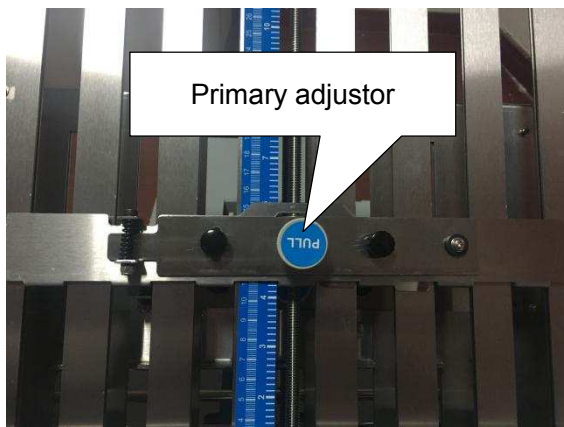













7. Function introduction



8. Technical parameters

1	Model	
2	Type	desktop
3	Paper size that can be folded	68~305 (W) ×128~432 (L)
4	Paper quality	Rough paper, fine quality paper, recycled paper,
5	Paper thickness	50gsm~120gsm
6	Processing speed	120 /min (A4)
7	Folding mode	P5
8	Loading capacity of paper feed table	500 sheets (64gsm)
9	Paper feed method	3 rings automatic paper separation method, slant correction device
10	Counter	Digital display, 4-digit for add count, 3-digit for subtract count
11	Folding stopper	Manual setting
12	Stacker roller	Manual setting 5 steps
13	Detection function	no paper, mis-feed, paper jam, motor overload
14	Power supply	AC220V~240V 50Hz
15	Power Consumption	0.4A 100W
16	Dimensions	1230(W1)×480(D)×560(H1)-Machine 480(W2)×480(D)×410(H2)-Package
17	Weight	44.5Kg

Folding style	Plates NO						Model
	1	2	3	4	5	6	
 Single fold	1/2	0	N O	N O	N O	N O	Two Plates Paper Folding Machine
 Letter fold	2/3	1/3	N O	N O	N O	N O	
 Z fold	1/3	1/3	N O	N O	N O	N O	
 Double fold	1/2	1/4	N O	N O	N O	N O	
 Outside fold	1/4	1/4	N O	N O	N O	N O	
 Kwan-yin fold	3/4	1/2	N O	N O	N O	N O	
 W fold	1/4	1/4	1/4	0	N O	N O	Four Plates Paper Folding Machine
 Accordion fold	1/5	1/5	1/5	1/5	N O	N O	
 Roller fold	3/4	1/4	0	1/4	N O	N O	
 Triple double fold	1/2	1/4	0	1/8	N O	N O	

 Single +Letter fold	1/2	1/6	1/6	0	N O	N O	Six Plates Paper Folding Machine
 Single +Z fold	1/2	1/6	0	1/6	N O	N O	
 Accordion fold	1/6	1/6	1/6	1/6	1/6	0	
 Accordion fold	1/7	1/7	1/7	1/7	1/7	1/7	
 Roller fold	4/5	1/5	0	1/5	0	1/5	
 Four double fold	1/2	1/4	0	1/8	0	1/1 6	
.....							



Sunfung Technology Corporation Ltd

Add: No 1191 Linding Road Jianggan District, Hangzhou, China

Tell: +86(0)571 8517 5095

Web: sunfung-tech.com

Email: info@sunfung-tech.com